

2300 Nesconet Highway, Stony Brook, NY

Available 3,000-7,800 Sq. Ft.



Former Boaters World location has great visibility with 80 feet of frontage on Route 347 (Nesconet Highway). Site has access to both 347 and Hallock Road (traffic light) with ample parking. Neighboring tenants include Lucille Roberts, Bagel, Womens Shoes, Sprint Store and a Travel Agency.



For more information, please contact:

Carol Modell (631) 209-1919

Cam275@aol.com

www.camrealestate.net

CAM Real Estate

595 Route 25A, Suite 1

Miller Place, NY, 11764

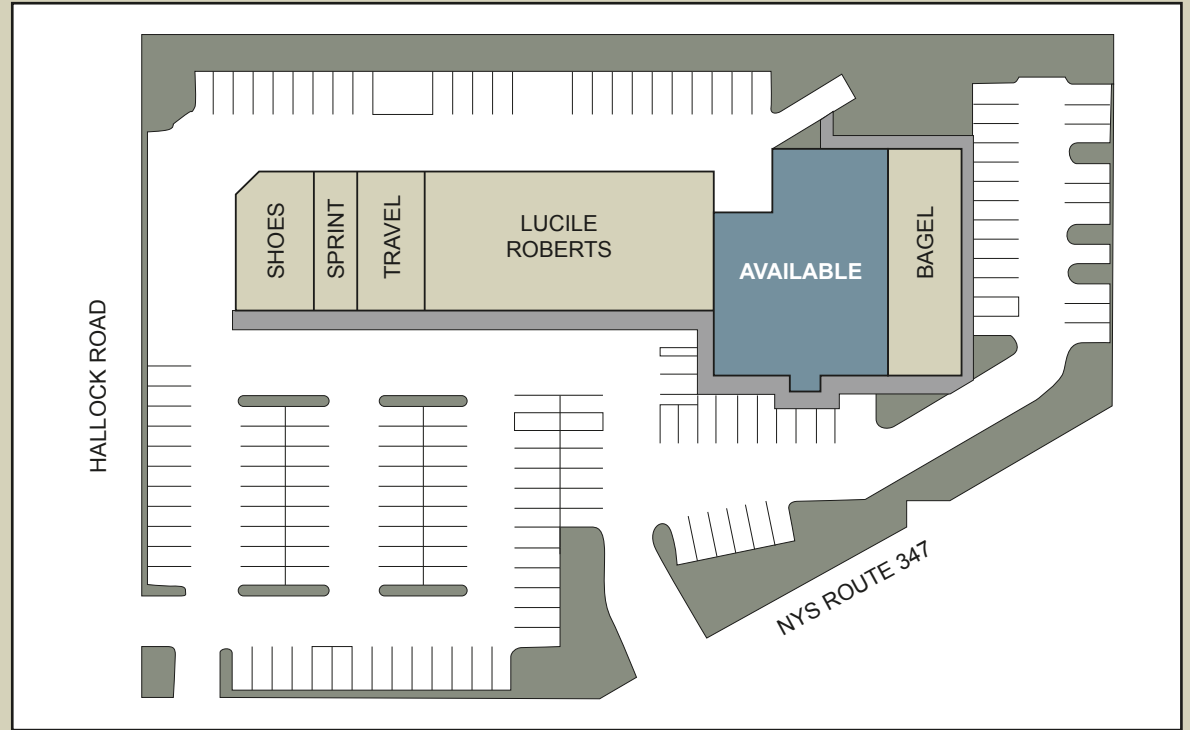
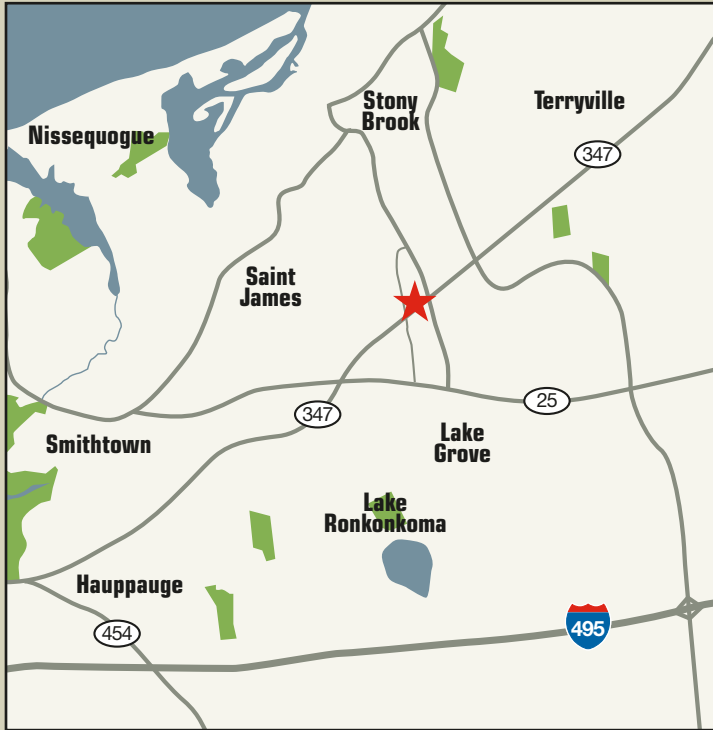

Demographic Summary	1 mile	3 mile	5 mile
Population	6,729	86,698	219,100
Household	2,362	27,307	72,254
Avg. Household Size (yr 2000)	1.9	2.5	2.4
Median Home Value (yr 2000)	\$209,611	\$209,592	\$202,599

For more information, please contact:

Carol Modell (631) 209-1919
 Cam275@aol.com
 www.camrealestate.net

CAM Real Estate
 595 Route 25A, Suite 1
 Miller Place, NY, 11764

